

Roof hoods E-line & S-line
Roof inlets EKO-T & EKO-TD

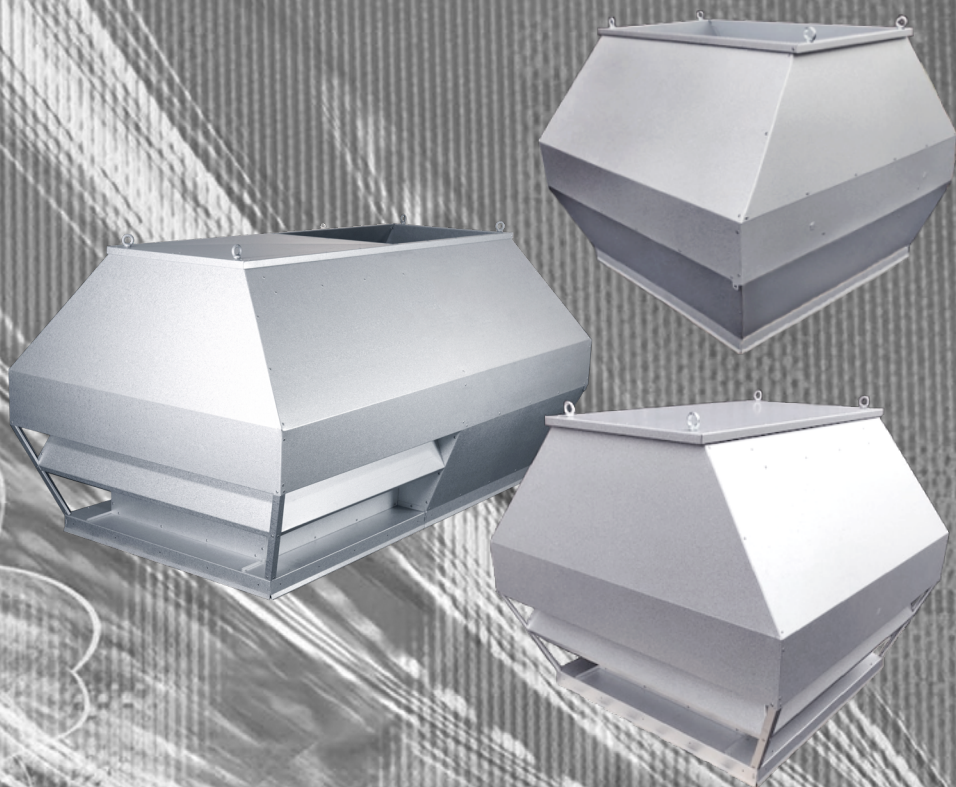

Installation and Maintenance Instructions 2025-06

Table of contents

General about the product2
Lifting instructions3
Anchoring of Roof hood3

Installation 5-8
Maintenance.....9

General about the product

Transport

The product is transported to the assembly site with a crane or forklift.

Important!

To avoid damage the product must be lifted, the product must not be pulled or lowered hard against the surface.

2

Checking delivered goods

Check the delivery for transport damage and ensure that it is complete as soon as it arrives. The approved delivery is acknowledged on the consignment note. Products with defects may not be installed. Contact the supplier immediately.

Storage

If you have to store the packages temporarily, store them in a dry, dust-free place. Do not expose them to any aggressive gases or liquids. Handle the product carefully to prevent any mechanical damage.

Commissioning

The product must not be used until the installation is in operational condition.

Personnel requirements

Assembly, installation, and commissioning must only be carried out by instructed personnel or by the manufacturer. Instructions in this manual must be followed. If you have any questions, contact the supplier.

EKOVENT AB hereby disclaims all responsibility for:

- Damage due to incorrect transport, handling or storage.
 - That the user has failed to inspect, maintain and to a reasonable extent take care of the equipment.
 - Personal injury or property damage as a result of the product has been used in violation of instructions and specifications in this manual.
- EKOVENT's liability shall be limited to repair or replacement of faulty equipment part.

Lifting instructions

Important!

Carefully read our instructions that apply to each product and size.

Use the designated lifting method and the designated lifting accessories.

- Lifting may be only performed by appropriately trained personnel.
- Lift only the product itself; do not attempt to lift people or other items when raising the roof hood.
- Do not stand under suspended loads.
- The lifting of products must only be carried out using lifting equipment approved for the intended purpose. Ensure approved shackles, lifting hooks, or sling hooks are used in combination with chains, slings, or straps.
- Use all four lifting points.
- Carefully check that the assigned lifting points are not damaged before lifting
- Ensure that the specified angle (20°) on the connecting lifting gear is not exceeded. Approved screws must be used for compensating angles or lengths.
- When lifting our roof hoods, adhere to the methods described for the specific hood model. We recommend using the H-yoke or frame-yoke when lifting products with four or more lifting points to ensure an evenly distributed load.
- The roof inlets are lifted separately.

3

Anchoring

All roof hoods are prepared for anchoring.

E-Line have lifting eyes than can be used.

S-Line has pre-punched holes that can be used if needed.

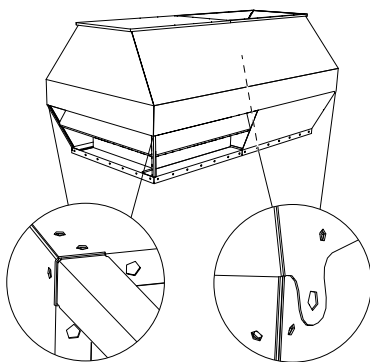

E-Line

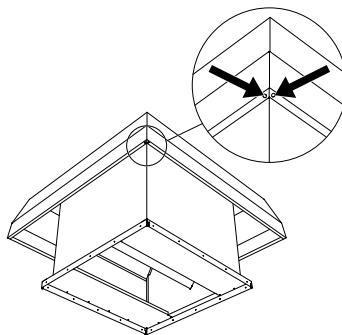

S-Line

Weight (kg)

4

<div>Model</div> <div>Size</div>	EKO- HAE	EKO- HUE	EKO- HKE	EKO- HAAS	EKO- HUAS	EKO- HKAS	<div>Model</div> <div>Size</div>	EKO- TD (EI30)	<div>Model</div> <div>Size</div>	EKO- T (EI30)
20	9	9	14	14	12	35	10	30	3	19
30	13	13	21	18	15	43	12	36	4	26
40	17	18	29	38	30	85	13	41	5	32
50	23	24	38	50	40	110	16	52	6	39
60	29	30	49	63	48	130	18	62	6,5	43
80	56	57	94	95	75	190	20	63	7	46
100	79	79	132	125	95	230	22	74	8	52
120	106	106	162	160	125	270	24	84	9	59
140	138	137	210	205	155	305	28	96	9,5	63
160	174	179	267	250	175	345	30	106	10	66
180	223	226	340				34	118	11	72
200	273	278	420				40	140	12	79
							42	150	13	85
							44	162	14	92
							46	184	15	98
							48	215	16	105
							50	255	17	111
									18	118
									19	125
									20	131
									21	138

Installation

Installation EKO-T and EKO-TD



- The roof inlet must be be at least 300 mm above the roof.
- For horizontal roofs, the cut out size installation of roof inlet is AxB + 20 mm.
- In the case of sloping roofs, the roof slope must be taken into account, see below.
- Roof inlet is mounted horizontally.

Important!

Follow the lifting instructions to perform safe lifting.

1. For EKO-TD: install the supplied D-sealing strip around and between the outdoor air and exhaust air openings.
2. Calculate the cut out size in the roof according to the charts and examples below.
3. Use the lifting points and place the roof inlet in the hole.
4. Secure the roof inlet to the ceiling with the mounting brackets (3) by screwing in the attachment points. Use self-drilling sheet metal screw 4.8x25 mm or equivalent.
5. Cover the roof inlet with plywood (2), roofing felt (1), sheet metal or other approved sealing method.

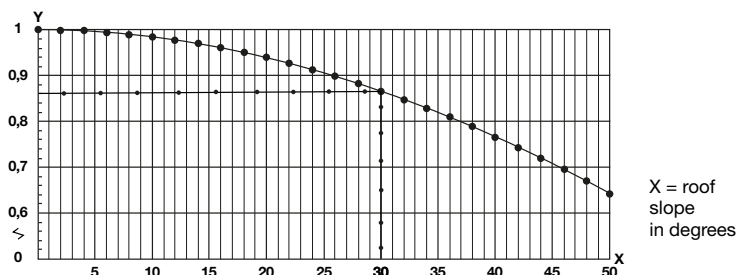

$$\text{Cut out size for sloping roof} = \frac{\text{Width Roof inlet (A)}}{\text{Constant Y according to diagram}} + 20 \text{ mm}$$

$$\text{Example roof slope 30 degrees} = \frac{900}{0,86} + 20 = 1067 \text{ mm}$$

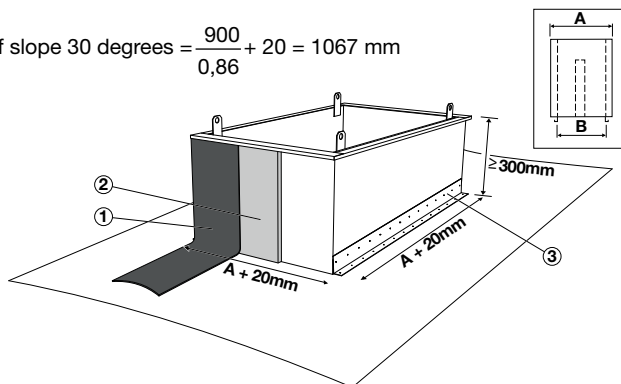

Installation of EKO-SUH S-Line (Adjustable outlet speed)

EKO-SUH is placed in the roof hood outlet and adapted to its attachment points in the hood.

1. Adjust the EKO-SUH to the desired position and lock with a sheet metal screw in the upper edge of the hood.
2. Lock EKO-SUH with blind rivet nut M10 and sheet metal screws.

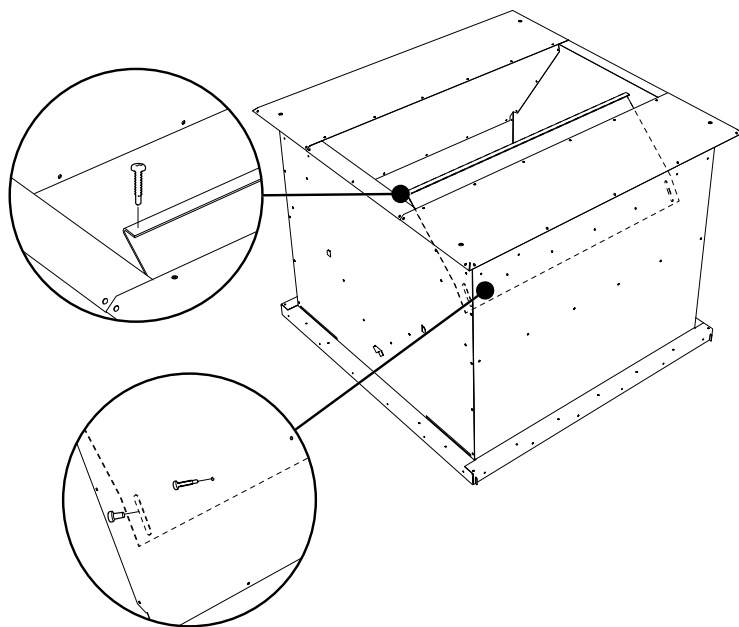

Calculate the desired area:

$$A = q/v$$

v = Desired outlet speed, m/s

q = Available air flow, m³/s

A = Outlet area, m² (AxB)

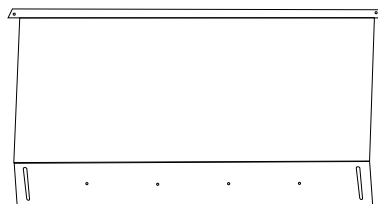

EKO-SUH

Installation of EKO-ESU E-Line (Adjustable Discharge Velocity)

Installation of ESU on EKO-HKE

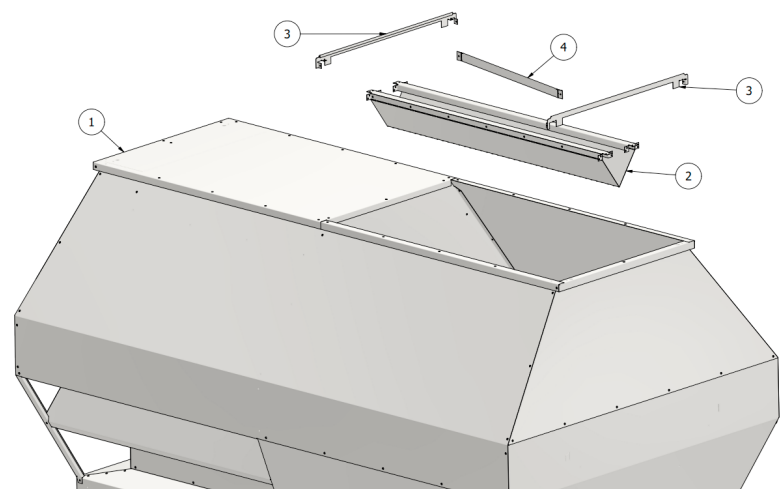

7

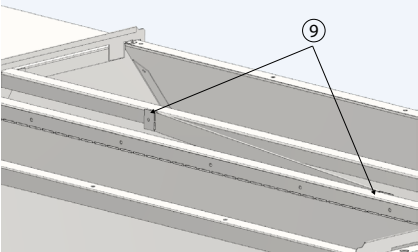
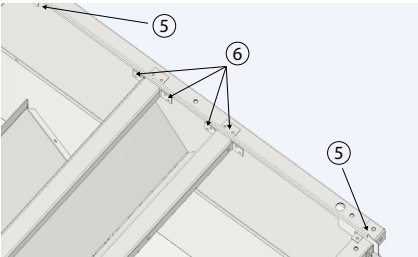
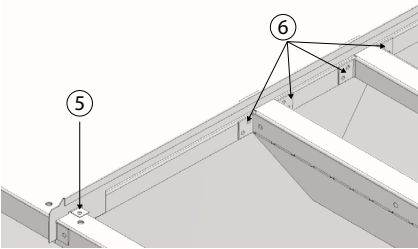
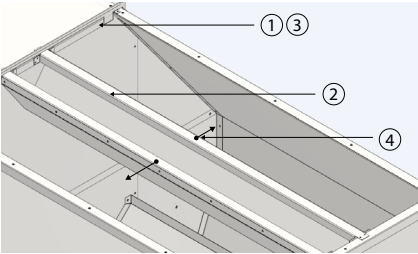

Assembly Instructions EKO-ESU

1. Install the locking strip.
2. Insert the EKO-ESU into the track.
3. Install the locking strip on the opposite side.
4. Adjust the EKO-ESU by pulling the wings to the desired position. (Refer to the table below for speed profiles.)
5. Fasten the locking strip to the ceiling hood with screws.
6. Screw the EKO-ESU to the partition wall.
7. Repeat steps 5 and 6 on the gable side.
8. Disassemble and remove the locking strips.
9. If the EKO-ESU is delivered with stabilizer rods, these must be screwed on both sides.

Discharge velocity

8

Angle °	Discharge Velocity Increase %
50	110
60	115
70	120
80	125
90	150
100	180

Installation of the mount frame

The mounting frame consists of four loose angle plates with foldable sheets in the corners.

1. Fold the plate 90°.
2. Bring the corners of the angle plates together.
3. Fold the plates another 90° so that they lock the angle plates together.

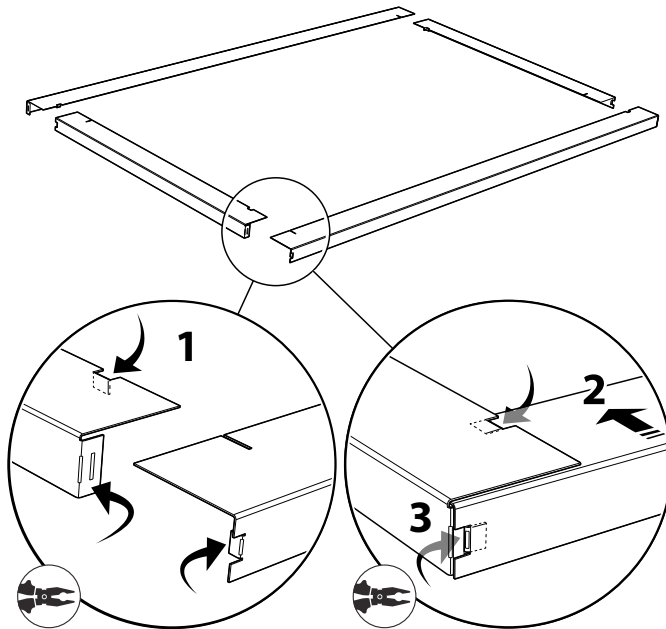

Installation of the mount frame

1. Place the mounting frame on the roof inlet.
2. Screw the mounting frame to the roof inlet.
Use self-drilling sheet metal screw 4.8 x 25 mm or equivalent.

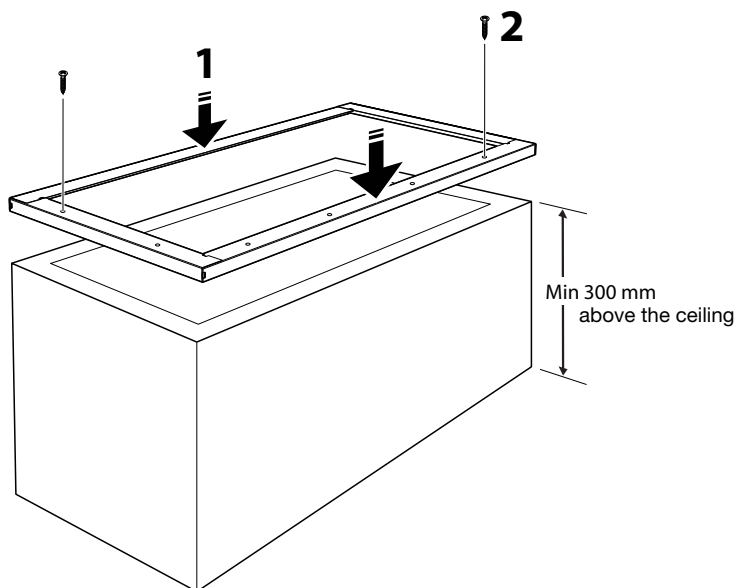

Installation of the Roof Hood

i

- Be sure to place the hood upright with exhaust air and outdoor air over each duct in the roof inlet. Roof hood and roof inlet are mounted horizontally.

Important! Follow the lifting instructions to perform safe lifting.

1. Use the lifting points and place the roof hood on the mounting frame.
2. Attach the hood to the mounting frame by screwing in the attachment points. Use self-drilling sheet metal screw 4.8 x 25 mm or equivalent.

NOTE!

- For combined hoods, the included sealing strip must be installed on the roof hood around and between the exhaust air and outdoor air openings.
- The sealing strip is installed after the mounting frame has been fitted.

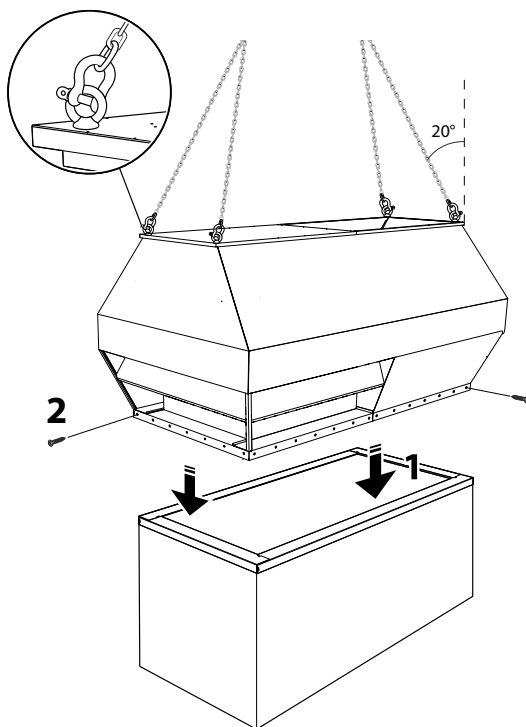

11

Maintenance

- Check and correct any visible damage.
- Ensure that the hood is properly attached to the roof inlet and that any stay lines are intact and taut.
- Check that the hood's wire mesh is securely mounted and free of visible damage.
- Remove any accumulation of leaves, dirt or snow.
- Make sure that no object obstructs the air flow.
- Inspect the drainage holes in the Roof hood that no dirt or leaves obstruct the water from running out of the hood.

Cleaning

- The requirement for cleaning corresponds to the requirements which is placed on the facility in general and the applicable product warranty.
- Do not clean the hood with a high-pressure cleaner.

Notes:

[illegible]



EKOVENT®

HEAD OFFICE
Mejselgatan 7, 235 32 Vellinge
Tel 040-42 16 00
www.ekovent.se info@ekovent.se

REGIONAL OFFICE UMEÅ
Strömvägen 1, 901 32 Umeå
Tel 090-13 33 01

REGIONAL OFFICE GÖTEBORG
Boräsvägen 5, 435 31 Mölnlycke
Tel 031-23 07 40

REGIONAL OFFICE STOCKHOLM
Medborgarplatsen 25, 118 72 Stockholm
Tel 08-508 613 00